

Local expertise with powerful national marketing



PARLOUR WAY
VENWOOD, BH31 7DQ

£1,650 PER MONTH

- Modern Home
- Three Bedrooms
- Master to En-Suite
- Downstairs Cloakroom
- Kitchen / Diner
- Garage & Driveway

GROUND FLOOR
663 sq.ft. (61.6 sq.m.) approx.

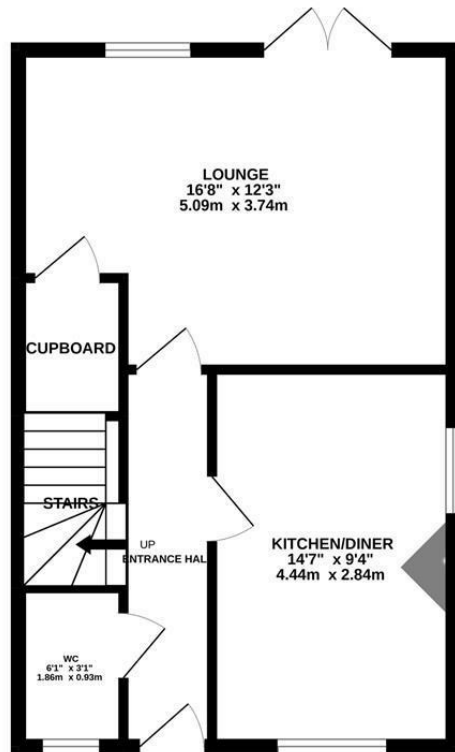

1ST FLOOR
442 sq.ft. (41.1 sq.m.) approx.

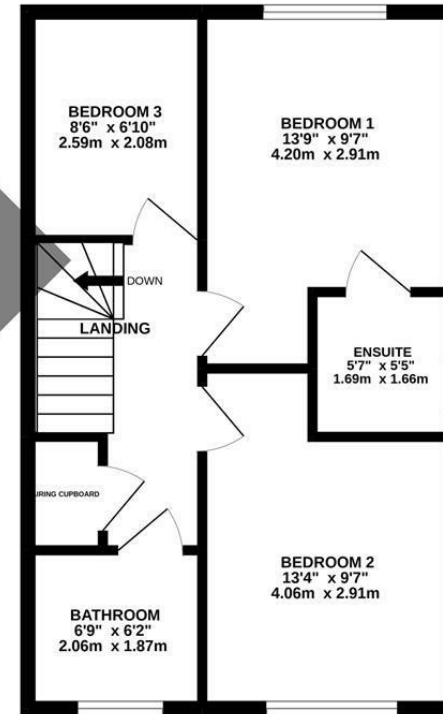

TOTAL FLOOR AREA : 1105 sq.ft. (102.6 sq.m.) approx.

Whilst every attempt has been made to ensure the accuracy of the floorplan contained here, measurements of doors, windows, rooms and any other items are approximate and no responsibility is taken for any error, omission or mis-statement. This plan is for illustrative purposes only and should be used as such by any prospective purchaser. The services, systems and appliances shown have not been tested and no guarantee as to their operability or efficiency can be given.
Made with Metropix ©2022

These particulars are believed to be correct but their accuracy is not guaranteed and they do not form part of any contract. Whilst every effort is made to ensure the accuracy of these details, it should be noted that the above measurements are approximate only. Floorplans are for representation purposes only and prepared according to the RICS Code of Measuring Practice by our floorplan provider. Therefore, the layout of doors, windows and rooms are approximate and should be regarded as such by any prospective purchaser. Any internal photographs are intended as a guide only and it should not be assumed that any of the furniture/ fittings are included in any sale. Where shown, details of lease, ground rent and service charge are provided by the vendor and their accuracy cannot be guaranteed, as the information may not have been verified and further checks should be made either through your solicitor/conveyancer or by referring to the home information pack for this property. Where appliances, including central heating, are mentioned, it cannot be assumed that they are in working order, as they have not been tested. Please also note that wiring, plumbing and drains have not been checked.

Local expertise with powerful national marketing



Ferndown, Dorset BH22 9AU

01202 039918

www.edwardstates.co.uk